

Cooling Fans

Accessories

Overview,
Product
Series

Axial Flow
Fans

AC Input
MU

AC Input
MRS

AC Input
Long-Life
MRE

DC Input
MDS
MD

DC Input
Low-Speed
Alarm
MDA

DC Input
Long-Life
MDE

Centrifugal
Blowers

AC Input
MB
DC Input
MBD

Cross Flow
Fans

AC Input
MF
DC Input
MFD

Cooling
Modules

Thermostat

Accessories

Accessories

Installation

Reference Page

Finger Guards.....	G-146
Filters, Metallic Filters.....	G-149
Screens.....	G-153
Plug Cords for Connection to Power Supply.....	G-154
Mounting Brackets for Centrifugal Blowers.....	G-155

Finger Guards RoHS

It is very dangerous to touch fan blades when the fan is running. Finger guards prevent fingers or foreign objects from entering the device.

Finger guards are installed to the installation holes of the fan frame using screws.

Material: Steel wire (**FGB8, FGB10, FGB12**: Resin)
 Finish: Chrome plating (**FG915D, FG930D**: Black painted)

Components conforming to safety standards: These finger guards are designed to pass tests required for devices that use fans, as stipulated by the UL and CSA Standards, and Electrical Appliance and Material Safety Law. However, they conform to these standards only when used with **ORIX FAN** products.

● For **MU** and **MD** Series, you can use installation screws included in each kit to install the finger guard on both sides of the fan (when the thickness of installation panel is 2 mm or less).

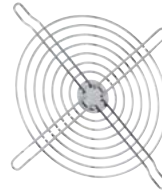

For Axial Flow Fan



For Centrifugal Blower

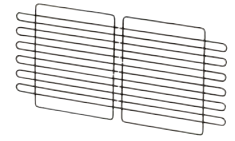

For Cross Flow Fan

[Installation Example]

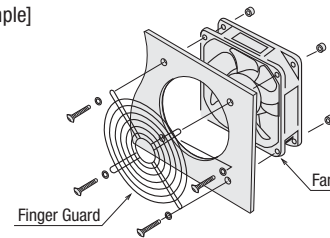

Dimensions (Unit mm)

Finger Guards for Axial Flow Fans

FG4D for MDS410

Component conforming to safety standards
 Mass: 4.2 g
CAD E085

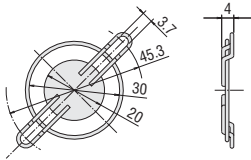

FG5D for MDS510

Component conforming to safety standards
 Mass: 7.7 g
CAD E086

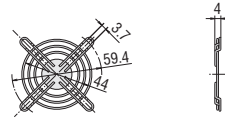

FG6D for MD625, MDA625

Component conforming to safety standards
 Mass: 8.3 g
CAD E087

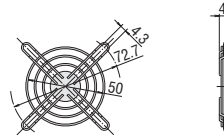

FG6E for MDS625, MDE625

Component conforming to safety standards
 Mass: 13 g
CAD E196

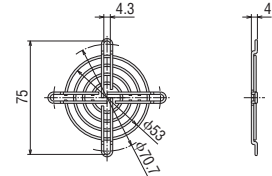

FG8D for MU825, MDS825, MD825, MDA825, MDE825

Component conforming to safety standards Mass: 23 g
CAD E048

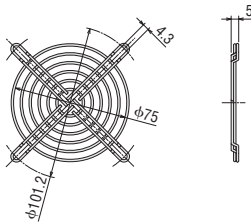

FG9D for MU925, MD925, MDA925

Component conforming to safety standards Mass: 28 g
CAD E049

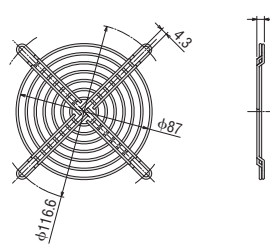

FG9E for MDS925, MDE925

Component conforming to safety standards Mass: 26 g
CAD E197

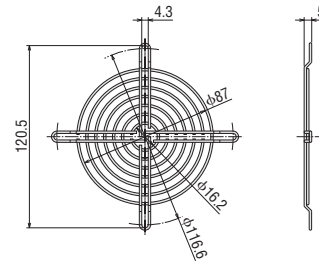

FG10D for MU1025

Component conforming to safety standards Mass: 34 g
CAD E050

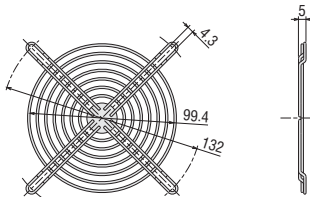

FG12D for MU1225, MU1238, MDS1225, MDS1238, MDA1225, MDE1225, MDE1238

Component conforming to safety standards Mass: 42 g
CAD E051

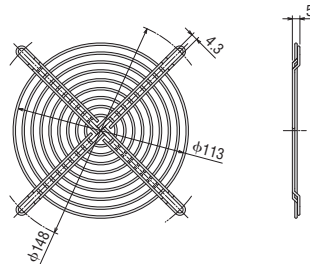

FG14D for MU1428, MRS14, MDS1451, MDA1451, MDE1451

Component conforming to safety standards Mass: 64 g
CAD E052

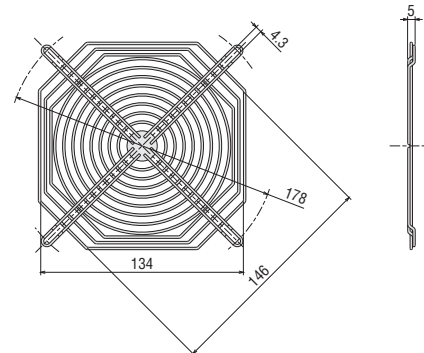

FG16D..... for MRS16, MRE16

Component conforming to safety standards Mass: 75 g

CAD E053

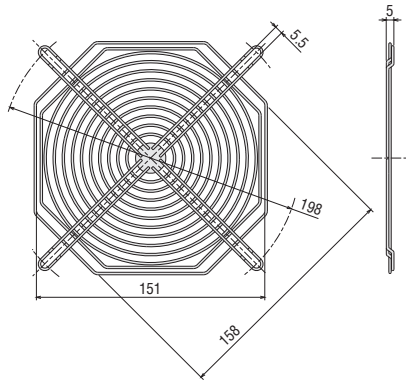

FG17D..... for MDS1751, MDE1751

Component conforming to safety standards Mass: 57 g

CAD E054

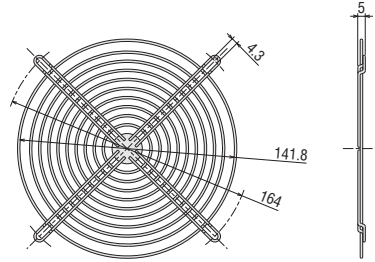

FG17DF..... for MDS1751F, MDE1751F

Component conforming to safety standards Mass: 65 g

CAD E195

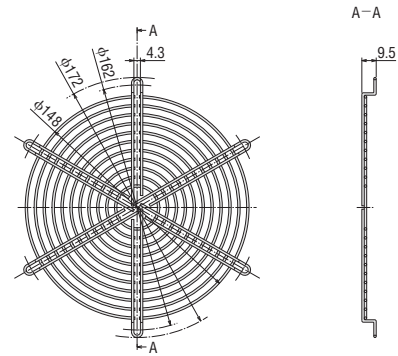

FG18D..... for MRS18, MRE18, MBS18

Component conforming to safety standards Mass: 95 g

CAD E055

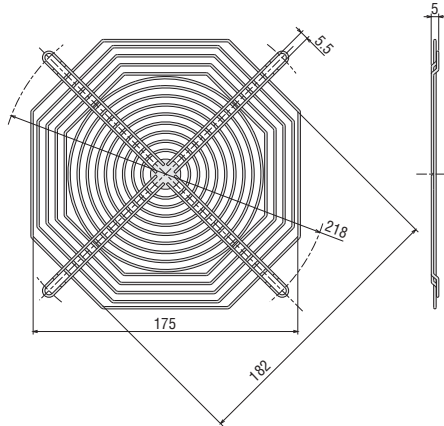

FG20D..... for MRS20

Component conforming to safety standards Mass: 105 g

CAD E056

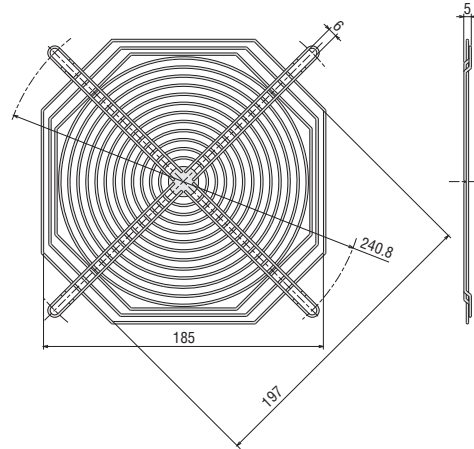

FG25D..... for MRS25

Component conforming to safety standards Mass: 160 g

CAD E107

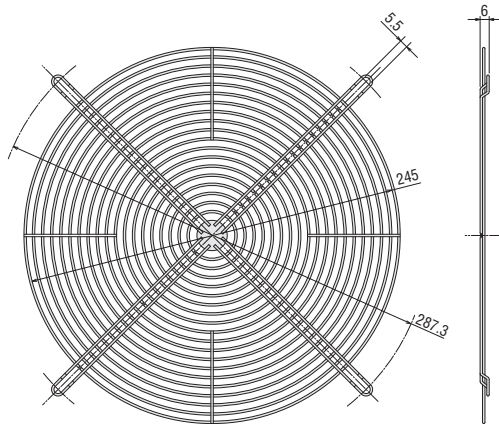

Overview,
Product
Series

Axial Flow
Fans

AC Input
MU

AC Input
MRS

AC Input
Long-Life
MRE

DC Input
MDS
MD

DC Input
Low-Speed
Alarm
MDA

DC Input
Long-Life
MDE

Centrifugal
Blowers

AC Input
MB
DC Input
MBD

Cross Flow
Fans

AC Input
MF
DC Input
MGD

Cooling
Modules

Thermostat

Accessories

Installation

Finger Guards

● Finger Guards for Centrifugal Blowers

FGB8..... for **MB840, MBD8**

Component conforming to safety standards Mass: 34 g
CAD E065

FGB10..... for **MB1040, MBD10**

Component conforming to safety standards Mass: 38 g
CAD E066

FGB12..... for **MB1255, MBD12**

Component conforming to safety standards Mass: 40 g
CAD E067

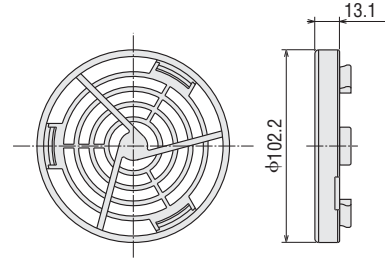
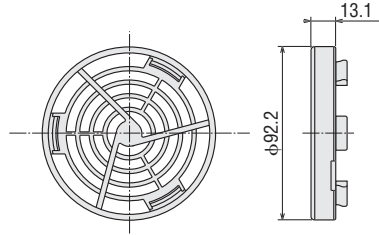
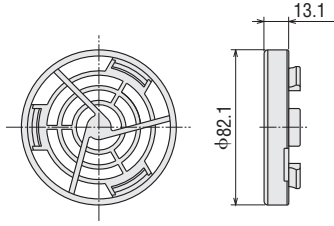

Filters

Screens

Plug Cords

Mounting Brackets

● Finger Guards for Cross Flow Fans

FG915D..... for **MF915(B), MFD915(B)**

Component conforming to safety standards Mass: 45 g
CAD E057

FG930D..... for **MF930(B), MFD930(B)**

Component conforming to safety standards Mass: 82 g
CAD E058

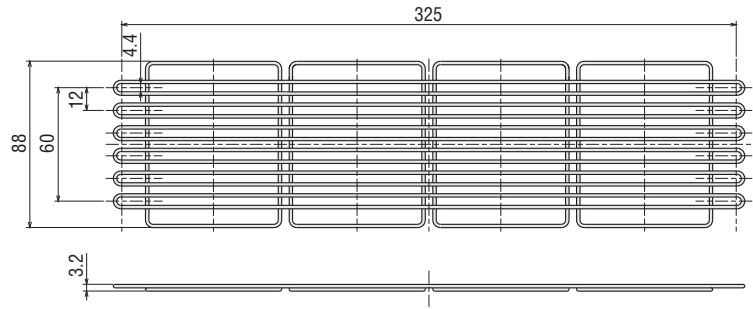
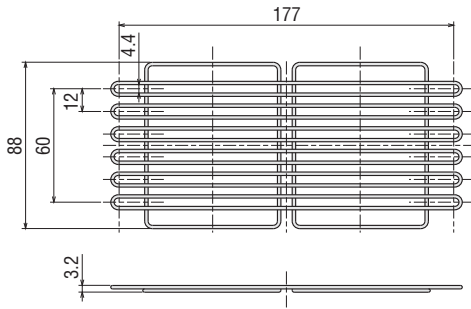

Filters RoHS

Metallic Filters RoHS

When using a fan to cool equipment, dust may accumulate as the fan sucks dust inside the equipment.

These filters prevent dust from entering and keep the air inside the equipment dust-free.

Additionally, because the material of the metallic filter is stainless metal, there is no worry of rust or corrosion and it is possible to remove deposits by washing or vacuuming with a vacuum cleaner.

The filter and metal filter consist of the following three parts:

Filter

- ① Guard : Plastic finger guard
Flammability classification: V-0
- ② Filter Media : Expanded polyurethane air cleaning filter media 20 to 45 PPI (PPI: The number of air bubble per inch)
- ③ Retainer : Plastic media retainer
Flammability classification: V-0

Metallic Filter

- ① Guard : Nylon resin finger guard
Flammability classification: V-0
 - ② Filter Media : Stainless media 30 mesh
(Mesh: Number of square holes per 1 inch)
 - ③ Retainer : Nylon resin media retainer
Flammability classification: V-0
- The filter media and the retainer of the filter and metallic filter can be attached and detached very easily for washing or other kinds of maintenance.

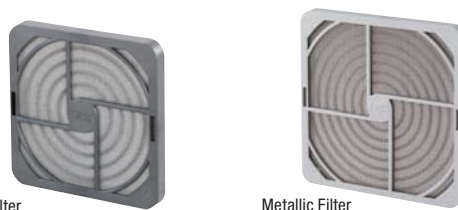

Filter

Metallic Filter

[Installation Example]

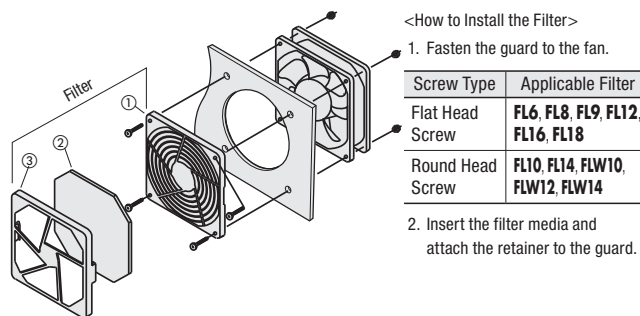

<How to Install the Filter>

1. Fasten the guard to the fan.

2. Insert the filter media and attach the retainer to the guard.

Example of Air Flow – Static Pressure Characteristics When Using a Filter

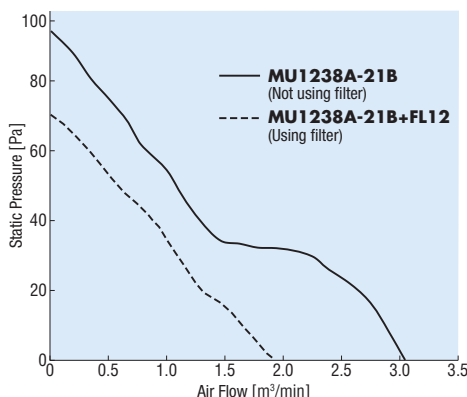

Dimensions (Unit mm)

Filters

FL6.....for **MDS625, MD625, MDA625, MDE625**

Mass: 11 g (Filter media: 45 PPI)

CAD E162

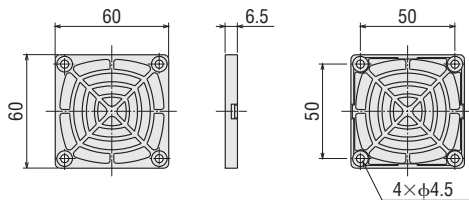

FL8.....for **MU825, MDS825, MD825, MDA825, MDE825**

Mass: 19 g (Filter media: 20 PPI)

CAD E163

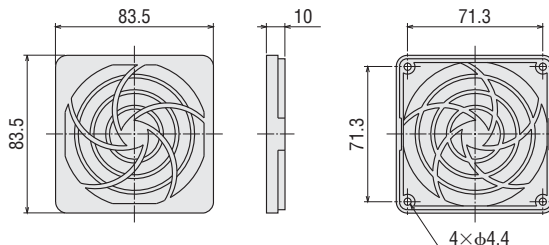

FL9.....for **MU925, MDS925, MD925, MDA925, MDE925**

Mass: 26 g (Filter media: 20 PPI)

CAD E164

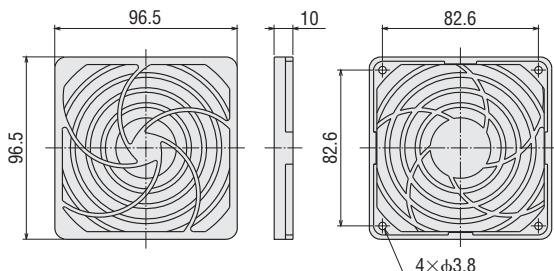

FL10.....for **MU1025**

Mass: 63 g (Filter media: 30 PPI)

CAD E165

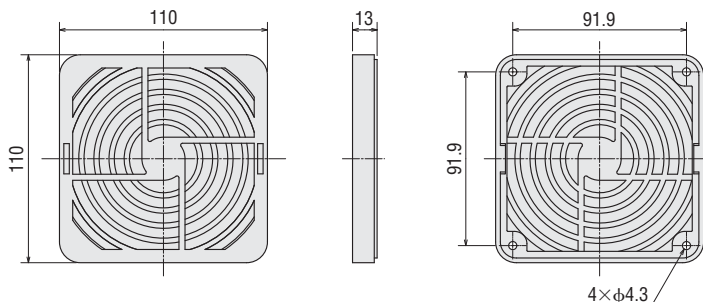

Finger Guards

Filters

Screens

Plug Cords

Mounting Brackets

FL12..... for **MU1225, MU1238, MDS1225, MDS1238, MDA1225, MDE1225, MDE1238**

Mass: 46 g (Filter media: 20 PPI)

CAD E166

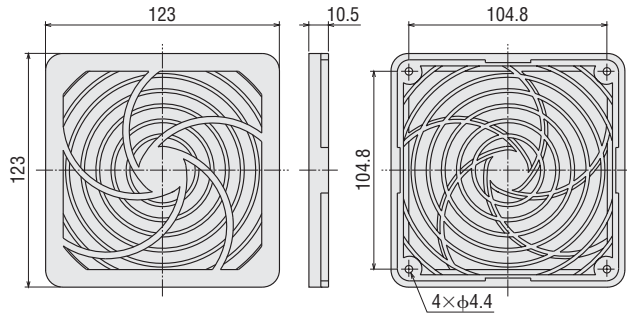

FL14..... for **MU1428, MRS14, MDS1451, MDA1451, MDE1451**

Mass: 92 g (Filter media: 30 PPI)

CAD E167

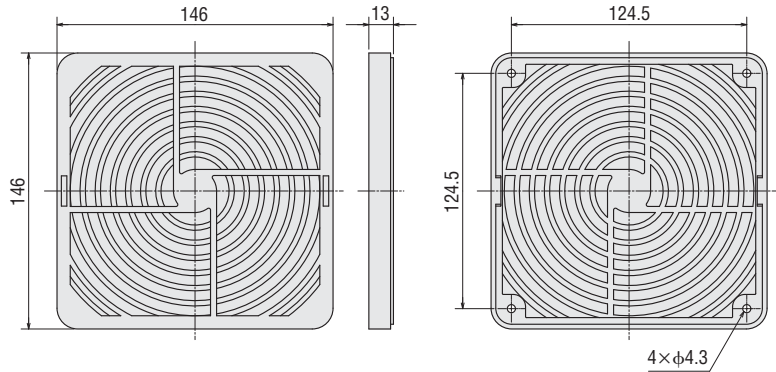

FL16..... for **MRS16, MRE16**

Mass: 126 g (Filter media: 30 PPI)

CAD E168

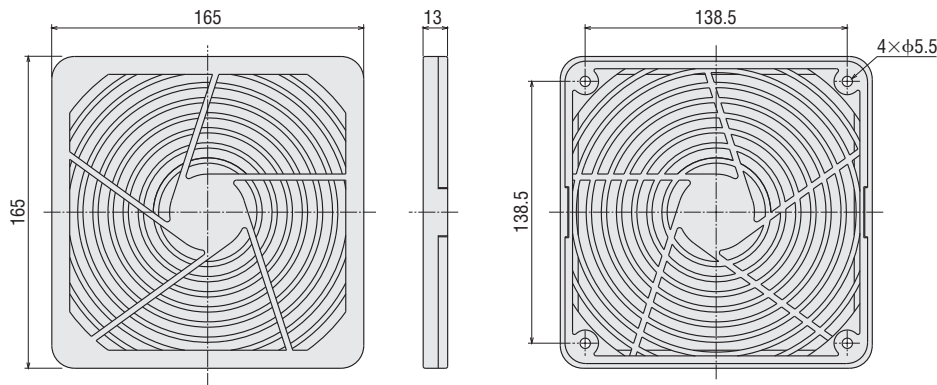

FL18..... for **MRS18, MRE18**

Mass: 165 g (Filter media: 30 PPI)

CAD E169

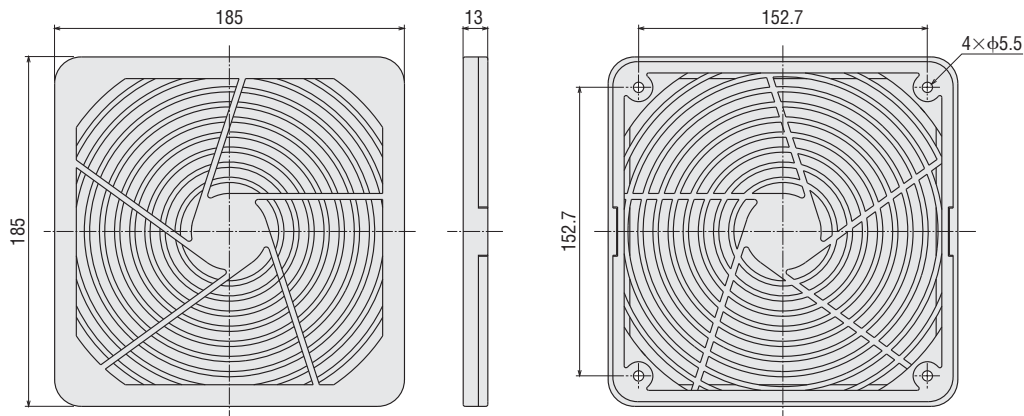

Metallic Filters

FLW10.....for MU1025

Mass: 86 g (Filter media: 30 mesh)

CAD E170

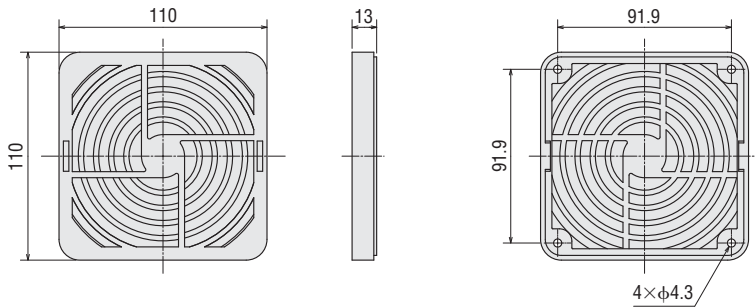

FLW12.....for MU1225, MU1238, MDS1225, MDS1238, MDA1225, MDE1225, MDE1238

Mass: 104 g (Filter media: 30 mesh)

CAD E171

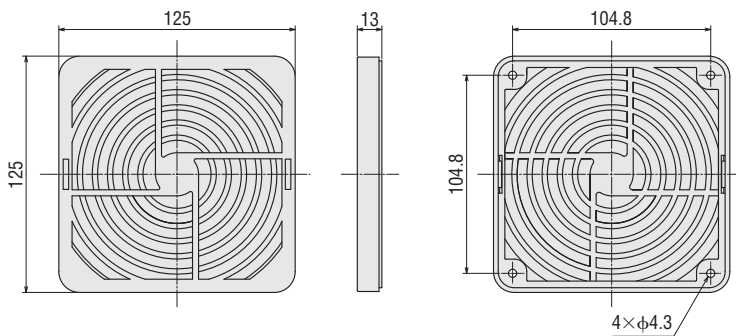

FLW14.....for MU1428, MRS14, MDS1451, MDA1451, MDE1451

Mass: 130 g (Filter media: 30 mesh)

CAD E172

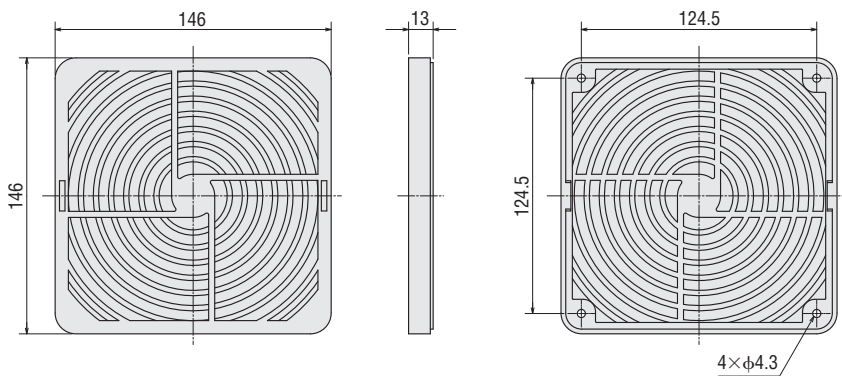

Replacement Filter Media

Filter Medias for Filters

Product Name	Applicable Filter
FLM6	FL6
FLM8	FL8
FLM9	FL9
FLM10	FL10
FLM12	FL12
FLM14	FL14
FLM16	FL16
FLM18	FL18

Filter Medias for Metallic Filters

Product Name	Applicable Filter
FLWM10	FLW10
FLWM12	FLW12
FLWM14	FLW14

Note

- One package contains five filter media for filters.
- One package contains one filter media for metallic filters.
- When ordering, please specify the quantity by the number of packages.

Overview,
Product
Series

Axial Flow
Fans

AC Input
MU

AC Input
MRS

AC Input
Long-Life
MRE

DC Input
MDS
MD

DC Input
Low-Speed
Alarm
MDA

DC Input
Long-Life
MDE

Centrifugal
Blowers

AC Input
MB
DC Input
MBD

Cross Flow
Fans

AC Input
MF
DC Input
MFD

Cooling
Modules

Thermostat

Accessories

Installation

● Filters for Centrifugal Blowers

Finger Guards

FLB8..... for **MB840, MBD8**
Mass: 41 g (Filter media: 30 PPI)

Filters

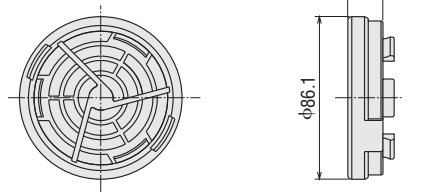

Screens

Plug Cords

FLB10..... for **MB1040, MBD10**
Mass: 47 g (Filter media: 30 PPI)

FLB10..... for **MB1040, MBD10**
Mass: 47 g (Filter media: 30 PPI)

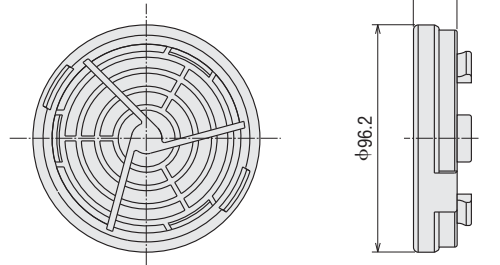

Mounting Brackets

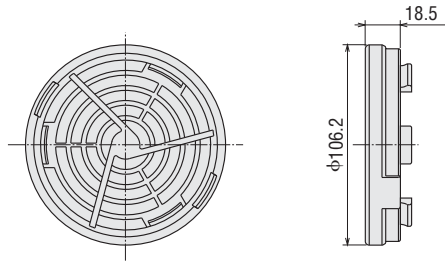

■ Replacement Filter Media

Product Name	Applicable Filter
FLBM8	FLB8
FLBM10	FLB10
FLBM12	FLB12

Note

- One package contains five filter media.
- When ordering, please specify the quantity by the number of packages.

Screens RoHS

When using fans to cool electronic devices that may generate electromagnetic waves, these waves can escape from the cooling holes of the fan and cause electromagnetic interference to computers and measuring devices.

The screens allow the passage of air, but block the electromagnetic waves.

The screen is a durable magnetic shield using a stainless mesh fixed to an aluminum frame and can be easily attached to the fan using screws.



[Installation Example]

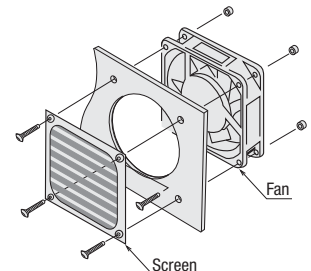

- Install from the flat side of the fan.
- To shut out electromagnetic waves, it is necessary to install such that there is no gap between the screen edges and the enclosure.

Overview,
Product
Series

Axial Flow
Fans

AC Input
MU

AC Input
MRS

AC Input
Long-Life
MRE

DC Input
MDS
MD

DC Input
Low-Speed
Alarm
MDA

DC Input
Long-Life
MDE

Centrifugal
Blowers

AC Input
MB
DC Input
MBD

Cross Flow
Fans

AC Input
MF
DC Input
MFD

Cooling
Modules

Thermostat

Accessories

Installation

Example of Air Flow – Static Pressure Characteristics When Using a Screen

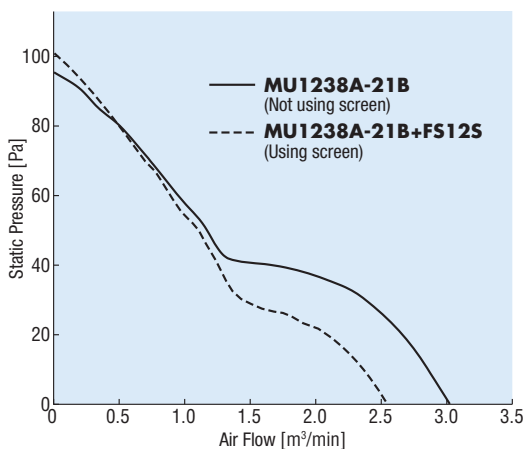

Dimensions (Unit mm)

FS6S for **MDS625, MD625, MDA625, MDE625**

Mass: 7 g

CAD E173

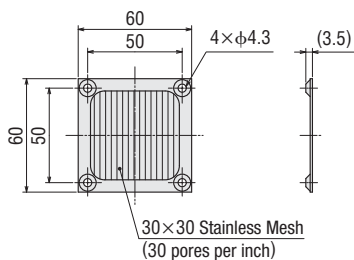

FS8S for **MU825, MDS825, MD825, MDA825, MDE825**

Mass: 15 g

CAD E174

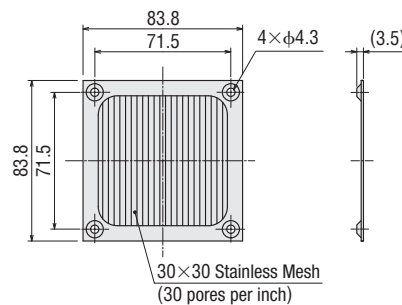

FS9S for **MU925, MDS925, MD925, MDA925, MDE925**

Mass: 16 g

CAD E175

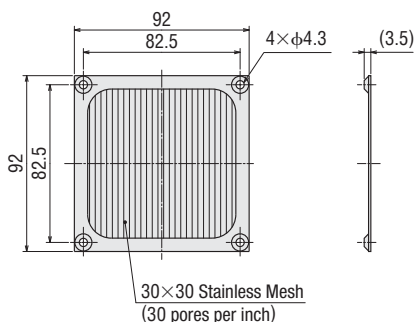

FS12S for **MU1225, MU1238, MDS1225, MDS1238, MDA1225, MDE1225, MDE1238**

Mass: 24 g

CAD E176

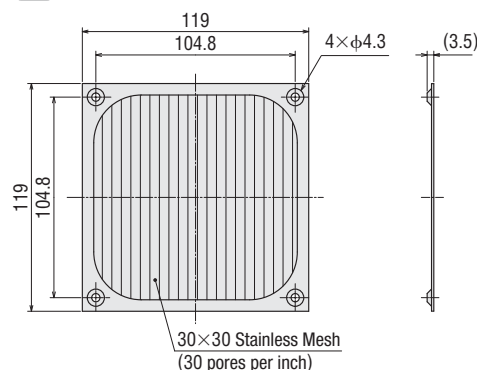

Plug Cords for Connection to Power Supply RoHS

This plug cord is for use with **MU** Series fans, which have terminals for connection to the power supply.



[Installation Example]

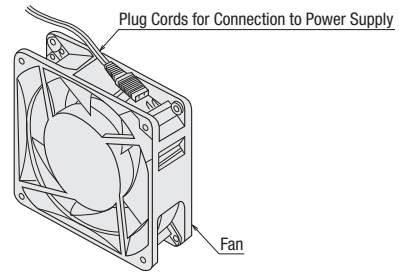

Dimensions (Unit mm)

PCA2B for **MU** Series: 1 m

● UL Recognized Component: UL File Number E46617 or E43202
 CSA Certified Component: CSA File No. LR68564 or UL File No. E43202 (The CSA Standards has been recognized by UL.)
 Electrical Appliance and Material Safety Law: The product is categorized as part of the special electrical appliances and materials and is subject to the compatibility tests performed by the Japan Electrical Safety and Environment Technology Laboratories (JET).

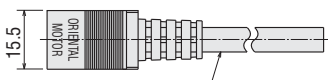
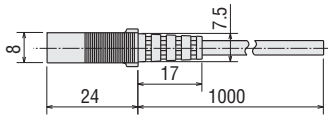

2-Core Flat Vinyl Cord (Black)
SPT-1 AWG18

PCA2B2 for **MU** Series: 2 m

● UL Recognized Component: UL File Number E46617 or E43202
 CSA Certified Component: CSA File No. LR68564 or UL File No. E43202 (The CSA Standards has been recognized by UL.)
 Electrical Appliance and Material Safety Law: The product is categorized as part of the special electrical appliances and materials and is subject to the compatibility tests performed by the Japan Electrical Safety and Environment Technology Laboratories (JET).

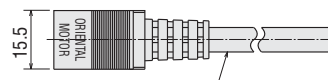
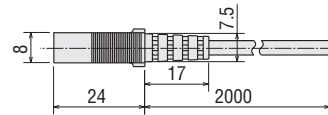

2-Core Flat Vinyl Cord (Black)
SPT-1 AWG18

Mounting Brackets for Centrifugal Blowers RoHS

Overview,
Product
Series

Mounting bracket for installing the motor case of the centrifugal blower.

[Installation Example]

Materials: **PAS2B, PAS4B**: Steel
PAS6A, PAS5A: Aluminum alloy
Color : Dark gray

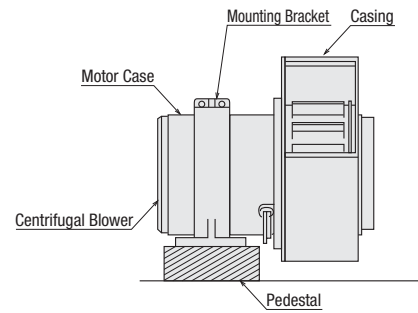

● A pedestal must be used when installing the blower so that the casing does not touch the installation surface of the mounting bracket.

Axial Flow
Fans

AC Input
MU

AC Input
MRS

AC Input
Long-Life
MRE

DC Input
MDS
MD

DC Input
Low-Speed
Alarm
MDA

DC Input
Long-Life
MDE

Centrifugal
Blowers

AC Input
MB
DC Input
MBD

Cross Flow
Fans

AC Input
MF
DC Input
MFD

Cooling
Modules

Thermostat

Accessories

Installation

Dimensions (Unit mm)

PAS2B.....for **MB520, MB630**

Mass: 52 g

CAD E088

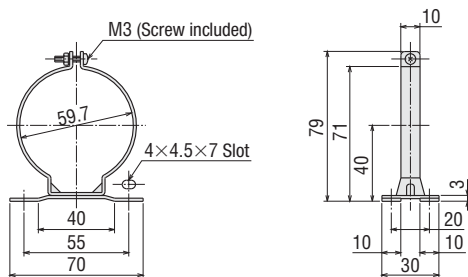

PAS4B.....for **MB840, MB1040, MBD8, MBD10, MBD12**

Mass: 125 g

CAD E089

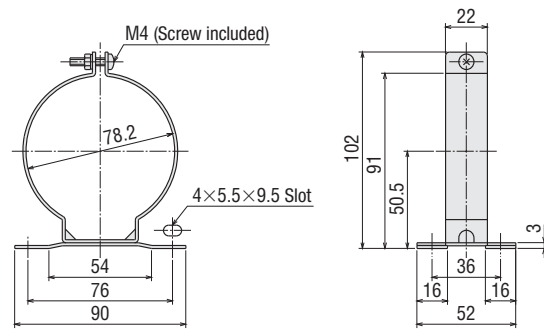

PAS6A.....for **MB1255**

Mass: 177 g

CAD E090

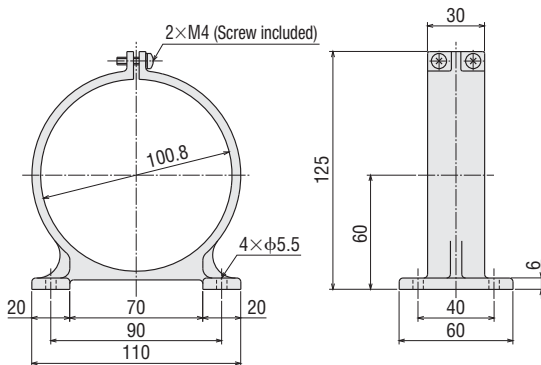

PAS5A.....for **MB1665**

Mass: 156 g

CAD E091

